

This design aims to meet the requirements of HPC to create a fun and varied play space for a wide range of ages and abilities. Circles of rubber mulch create a visually interesting and contemporary layout and provide individual safety surface zones for each piece of equipment. The climbing and play equipment for the older and younger children have been located at opposite sides of the space to separate the age groups. A tarmac path connects to the existing entrance area and links to all the elements to ensure the perimeter grass has minimal wear.



Rubber mulch safety surface in three different colours provides a durable, permeable and natural looking surface around the structures



In-ground trampoline



Wide DDA compliant gate



DDA compliant roundabout



Large bespoke creative climbing structure with central funnel net and four net elements with different levels of challenge for older children

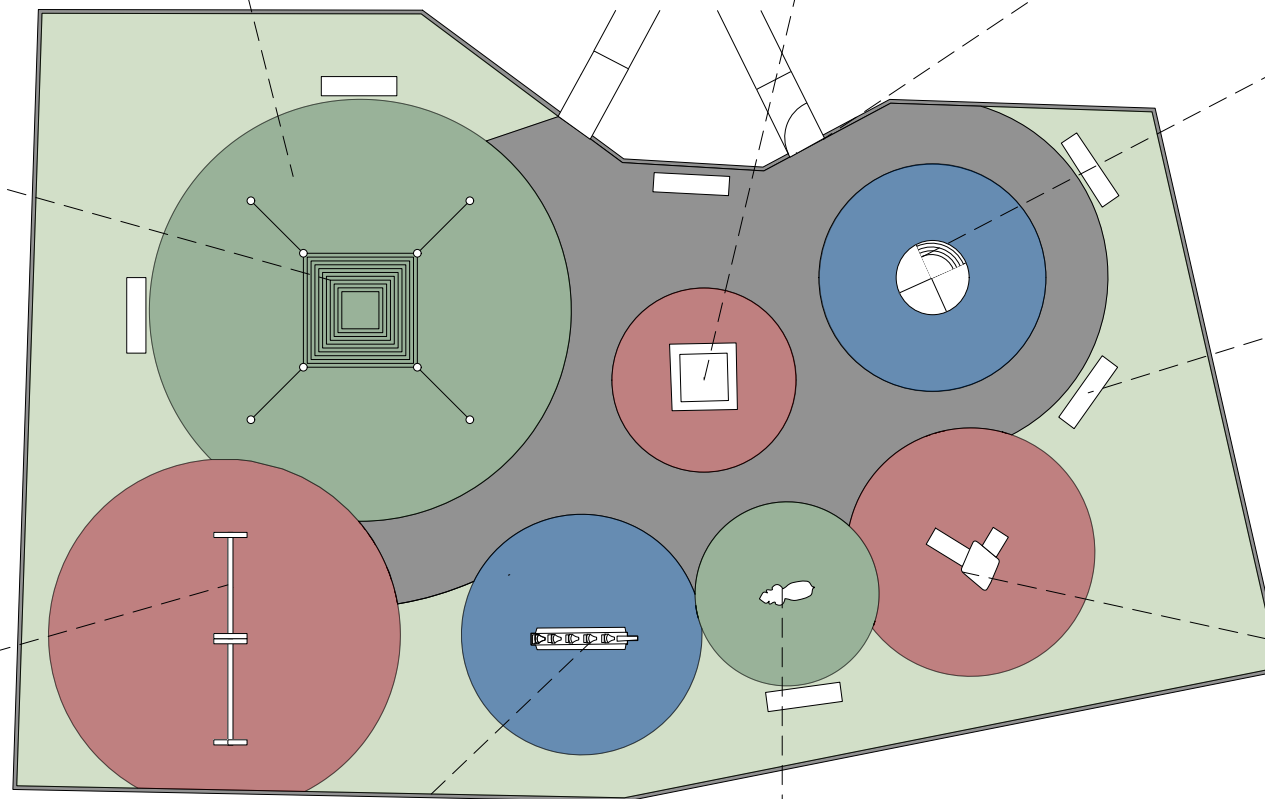

Existing benches to be refurbished and relocated



Smaller climbing unit with slide



Existing swings to be refurbished and toddler swings to be relocated next to the bigger swings (swings swapped over so bigger swings are closer to the large climbing structure)



Rocking Horse



Donkey Springer

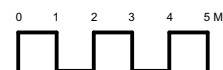

Please note this is a concept plan and changes may have to be made on site as our work is bespoke. We will always seek clients approval before changes are made.

1:200 @ A3

Title Hook Play Area Refurbishment		
Drawing Number 001	Drawn By NS/JN	Date 06/07/2017
CAD File Name HPAR01		

